



## FEATURES:

---



12 Occupancy



3 Bedroom



2 Bathroom



1 Car Parking

## ABOUT THIS PROPERTY

---

Lawlers apartments have been a long-standing favourite with groups and families for many years due to their proximity to the centre of the Hotham Village, chair lifts, shuttle bus, restaurants and bars that Hotham has to offer.

Lawlers 29 is a recently renovated, two level, three-bedroom, two-bathroom apartment with great views. There are 2 family rooms making it a perfect apartment for 2 families to reside together with the kids and parents able to have their own space.

This beautifully presented apartment has a wonderful feel and you will immediately feel like you are at home in the mountains.

This apartment also includes one car space in Lawler's car park. Resort access permits are still required through Alpine Easy Access for the duration of your stay.

Check-In: After 4pm Check-out: Before 10am

Over Snow: 2 trips IN and 2 trips OUT included to assist with your luggage.

## KITCHEN & COOKING FACILITIES

---

Full Kitchen  
Dishwasher  
Microwave  
Full Size Oven  
4 Burner Cooker

Nespresso coffee pod machine

## BEDROOMS & BEDDING CONFIGURATION

---

This property sleeps 12 people.

There are 3 Bedrooms with the following configuration

Bedroom 1: 1 x Queen Bed, 1 x Bunk Bed

Bedroom 2: 2 x Bunk Beds

Bedroom 3: 1 x Queen Bed, 2 x Single Beds

Linen, Towels and Bedding is provided for all beds.

## BATHROOMS

---

2 Bathrooms

Main Bathroom with Shower, vanity, washing machine & dryer. Separate powder room

Second Bathroom with Vanity & shower, separate powder room

## HEATING & COOLING FACILITIES

---

Heating - Electric Panel

## LAUNDRY DETAILS

---

Washing Machine  
Tumble Dryer



Drying Room for Ski Gear

## ENTERTAINMENT FACILITIES

---

Smart TV - Over 40 Inch

Multiple TV's

## PARKING

---

Car Park - Lawlers Car Park, resort entry required

## PETS

---

Strictly no pets allowed

## SMOKING

---

Strictly no smoking



## Lawlers Apartments, Apartment 29

29/Building 4, Lawlers Court, Mount Hotham



MT HOTHAM  
ACCOMMODATION

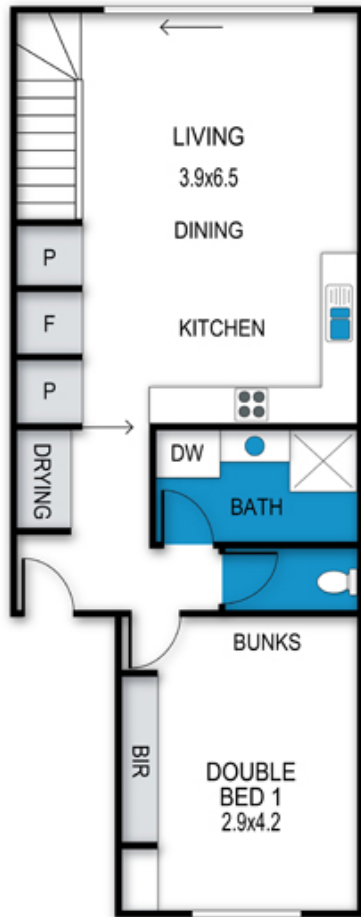

archistyle

Whilst every attempt has been made to ensure the accuracy of this floorplan, measurements of doors, windows, rooms and any other items are approximate only. The producer or the agent cannot be held responsible for any errors, omissions or misstatements. This plan is for illustrative purposes only and should be used as such.