

Alpine Heights 19

19/6 Lawlers Court, Hotham Heights, VIC. 3741



MT HOTHAM
ACCOMMODATION



FEATURES:



2 Occupancy



1 Bedroom



1 Bathroom



Strict NO Party Policy



Strict NO Pets Accepted



Linen Included

ABOUT THIS PROPERTY

Our 2 share Alpine Heights 19 is ideal for couples on a romantic getaway, or just 2 mates who need no fuss accommodation for their snow holiday. These rooms feature a kitchenette with microwave, toaster kettle and fridge, private ensuite, amazing mountain views and a flat-screen TV and DVD player.

Check-In: After 4pm **Check-out:** Before 10am.

Over Snow: 1 trip IN and 1 trip OUT included to assist with your luggage.

[Click Here To See Mt Hotham Village Directory](#)

KITCHEN & COOKING FACILITIES

Toaster, Electric Kettle, Kitchenware, Kitchenette, Full-size refrigerator, Convection Microwave

BEDROOMS & BEDDING CONFIGURATION

Studio: 1 x King bed*

*King can be split into 2 single beds, please call the office to request

BATHROOMS

1 x Bathroom

HEATING & COOLING FACILITIES

Hydronic Heating

LAUNDRY DETAILS

Guest Laundry - Coin Operated

ENTERTAINMENT FACILITIES

Flat-screen TV, DVD Player,

EXTRA FACILITIES

- Swimming Pool
- Spa
- Sauna
- Onsite Ski Hire
- Communal Drying Room

PARKING

Hotham overnight car parking - **Resort Entry will need to be purchased**

SMOKING

Alpine Heights 19

19/6 Lawlers Court, Hotham Heights, VIC. 3741



MT HOTHAM
ACCOMMODATION

This is a Non-Smoking Apartment

Alpine Heights, Apartment 19

19/6 Lawlers Court, Mount Hotham



MT HOTHAM
ACCOMMODATION

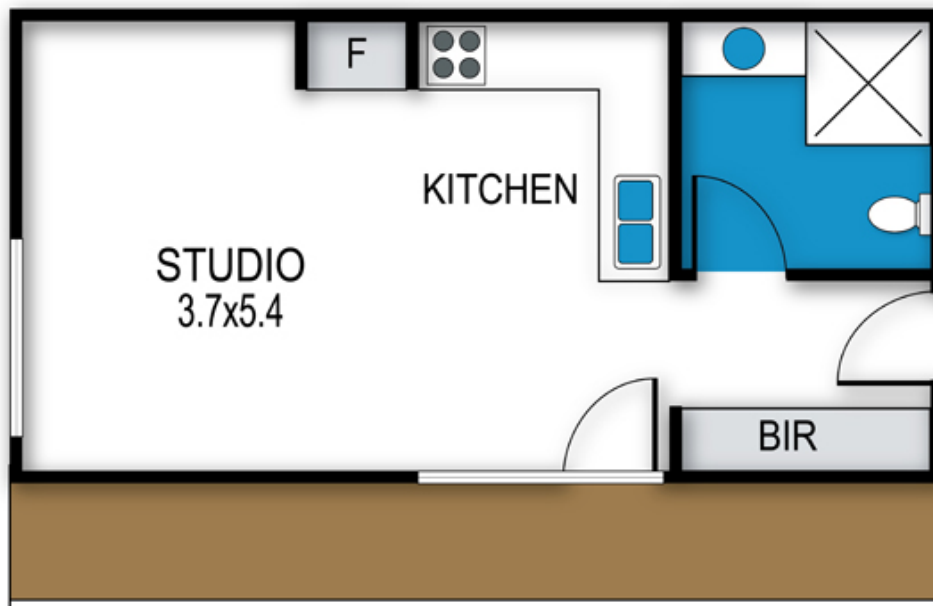

archistyle

Whilst every attempt has been made to ensure the accuracy of this floorplan, measurements of doors, windows, rooms and any other items are approximate only. The producer or the agent cannot be held responsible for any errors, omissions or misstatements. This plan is for illustrative purposes only and should be used as such.

Alpine Heights 19

19/6 Lawlers Court, Hotham Heights, VIC. 3741



MT HOTHAM
ACCOMMODATION

