

Razorback 8

8/2 Razorback Access, Hotham Heights, VIC. 3741



FEATURES:



8 Occupancy



3 Bedroom



2 Bathroom



Dish Washer



Washing Machine

ABOUT THIS PROPERTY

Razorback apartments have some of the most commanding views of Mt Hotham and the ranges beyond. These North facing apartments are bathed in sun on those perfect Hotham bluebird days where you can sit and just enjoy the natural beauty Hotham offers. Razorback 8 is a three-bedroom, 2 bathroom apartment with private balcony and great views over the Ski Runs.

Check-In: After 3.30 pm **Check-Out:** From 8 am - 10 am

Check-In Location: Proceed to the Corral Day Car Park and park in the loading zone next to the medical centre - You will then be required to come into our office located at Chalet Hotham to formalise your arrival and directions to Razorback Apartments will be provided

Over Snow: 2 trips IN and 2 trips OUT included to assist with your luggage.

[Click Here To See Mt Hotham Village Directory](#)

KITCHEN & COOKING FACILITIES

Full Kitchen - dishwasher, coffee machine, and Nespresso Pod Machine.

BEDROOMS & BEDDING CONFIGURATION

Bedroom 1: 1 x King Bed

Bedroom 2: 1 x Queen bed

Bedroom 3: 2 x Bunk beds

Linen, Towels and Bedding is provided for all beds.

BATHROOMS

2 x Bathrooms

HEATING & COOLING FACILITIES

Electric Panel heating

LAUNDRY DETAILS

- Washing Machine
- Dryer

ENTERTAINMENT FACILITIES

Large Smart TV, Playstation 3 in upstairs double bedroom.

EXTRA FACILITIES

Drying Room



PARKING

Hotham overnight car parking - **Resort Entry will need to be purchased**

SMOKING

This is a Non-Smoking Apartment

Razorback 8

8/2 Razorback Access, Hotham Heights, VIC. 3741

Razorback, Apartment 8

8_2 Razorback Acc, Mt Hotham

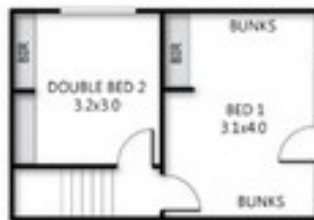

archistyle

Whilst every attempt has been made to ensure the accuracy of this floorplan, measurements of doors, windows, rooms and any other items are approximate only. The producer or the agent cannot be held responsible for any errors, omissions or misstatements. This plan is for illustrative purposes only and should be used as such.

Razorback 8

8/2 Razorback Access, Hotham Heights, VIC. 3741



MT HOTHAM
ACCOMMODATION

