

Alpine Heights 18

18/6 Lawlers Court, Hotham Heights, VIC. 3741



MT HOTHAM
ACCOMMODATION



FEATURES:



2 Occupancy



1 Bedroom



1 Bathroom



Strict NO Party Policy



Strict NO Pets Accepted



Linen Included



ABOUT THIS PROPERTY

Our 2 share Chalet Rooms are ideal for couples on a romantic getaway, or just 2 mates who need no fuss accommodation for their snow holiday. These rooms feature a kitchenette with microwave, toaster kettle and fridge, private ensuite, amazing mountain views and a flat-screen TV and DVD player. All rooms can be made to your requirements in either a King Bed or 2 Singles.

Check-In: After 4pm **Check-out:** Before 10am.

Over Snow: 1 trip IN and 1 trip OUT included to assist with your luggage.

[Click Here To See Mt Hotham Village Directory](#)

KITCHEN & COOKING FACILITIES

Toaster, Electric Kettle, Kitchenware, Kitchenette, Microwave

BEDROOMS & BEDDING CONFIGURATION

Studio: 1 x King Bed*

*King can be split into 2 single beds, please call the office to request

BATHROOMS

1 x Bathroom

HEATING & COOLING FACILITIES

Hydronic Heating

LAUNDRY DETAILS

Guest Laundry - Coin Operated

ENTERTAINMENT FACILITIES

Flat-Screen TV, DVD Player

EXTRA FACILITIES

- Swimming Pool
- Spa
- Sauna
- Communal Drying Room

PARKING

Hotham overnight car parking - **Resort Entry will need to be purchased**

Alpine Heights 18

18/6 Lawlers Court, Hotham Heights, VIC. 3741

SMOKING

This is a Non-Smoking Apartment

Alpine Heights, Apartment 18 18_6 Lawlers Court, Mt Hotham

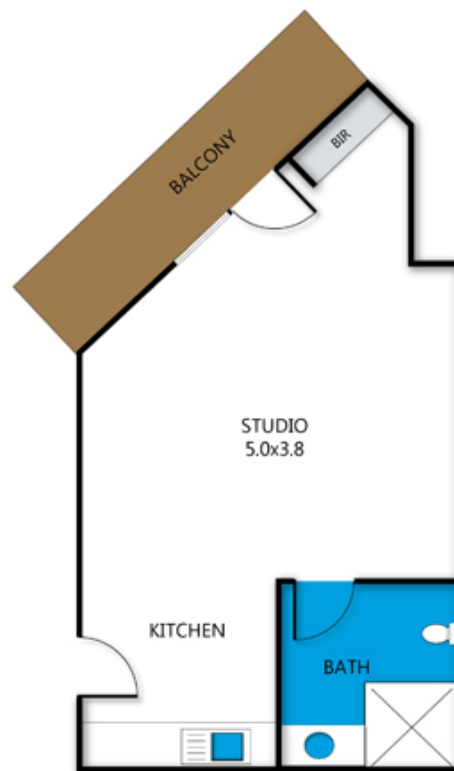

orchistyle

Whilst every attempt has been made to ensure the accuracy of this floorplan, measurements of doors, windows, rooms and any other items are approximate only. The producer or the agent cannot be held responsible for any errors, omissions or misstatements. This plan is for illustrative purposes only and should be used as such.

Alpine Heights 18

18/6 Lawlers Court, Hotham Heights, VIC. 3741



MT HOTHAM
ACCOMMODATION

