

Alpine Haven 5

5/13 Higgi Drive, Hotham Heights, VIC. 3741



MT HOTHAM
ACCOMMODATION



FEATURES:



4 Occupancy



1 Bedroom



1 Bathroom



Strict NO Party Policy



Strict NO Pets Accepted



Full Kitchen



Microwave



Washing Machine



Full Size Fridge



ABOUT THIS PROPERTY

Located in the popular Alpine Haven complex and only about a 350m walk to Hotham Central, this apartment offers every convenience for a perfect snow holiday.

Check-In: After 4pm **Check-out:** Before 10am.

Over Snow: 1 trip IN and 1 trip OUT included to assist with your luggage.

[Click Here To See Mt Hotham Village Directory](#)

KITCHEN & COOKING FACILITIES

Full Kitchen

- Full Size Fridge
- Dishwasher
- Microwave
- Coffee Pod Machine
- Full Size Oven
- 4 Burner Cooker

BEDROOMS & BEDDING CONFIGURATION

Bedroom 1:- 1 x Queen Bed & 1 x Single Bunk Bed

BATHROOMS

1 x Bathroom

HEATING & COOLING FACILITIES

Electric panel heating

LAUNDRY DETAILS

Shared Guest Laundry - Coin Operated

ENTERTAINMENT FACILITIES

Flat screen TV

EXTRA FACILITIES

Ski lockers at entry

PARKING

Hotham overnight public car parking - **Resort Entry will need to be purchased**

SMOKING

Alpine Haven 5

5/13 Higgi Drive, Hotham Heights, VIC. 3741



This is a Non-Smoking Apartment

Alpine Haven, Apartment 5

5/13 Higgi Drive, Mount Hotham

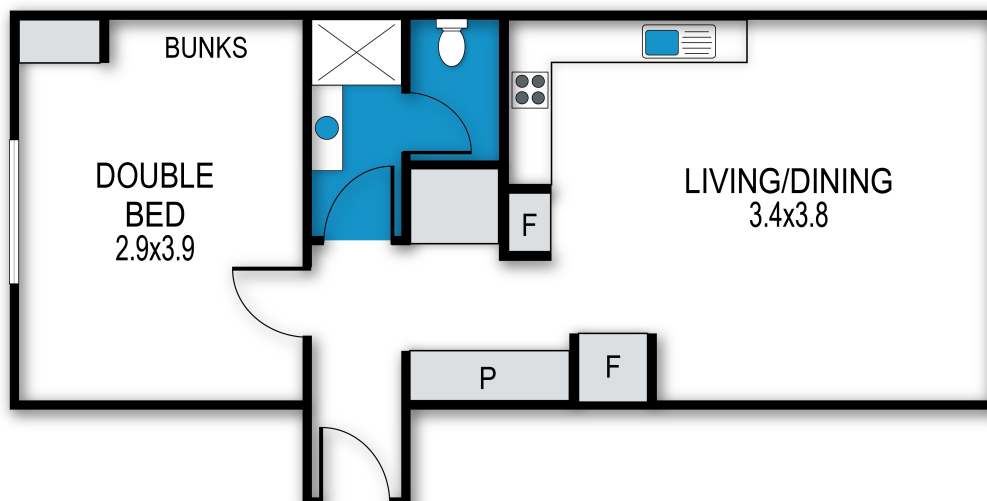

archistyle

Whilst every attempt has been made to ensure the accuracy of this floorplan, measurements of doors, windows, rooms and any other items are approximate only. The producer or the agent cannot be held responsible for any errors, omissions or misstatements. This plan is for illustrative purposes only and should be used as such.

Alpine Haven 5

5/13 Higgi Drive, Hotham Heights, VIC. 3741



MT HOTHAM
ACCOMMODATION

