

Shamrock 8

2 Gallows Court, Hotham Heights



MT HOTHAM
ACCOMMODATION



FEATURES:



4 Occupancy



2 Bedroom



1 Bathroom

ABOUT THIS PROPERTY

The Shamrock apartments offer self-contained apartment-style accommodation. Shamrock 8 is an affordable option for your next winter holiday and is located in the Davenport area of Mt Hotham. The apartment features cooking facilities with a full fridge, stove & microwave. There is a shared laundry and drying room in the building and a manager on-site to assist if needed.

The Hotham Village Bus stop is located a short walk from Shamrock to take you throughout the Village & around the resort. The General Store is also just a short walk away, featuring a licensed supermarket, post office, restaurant & bar. Shamrock is close to the Big D beginners ski area, which also houses kids ski hire and ski school. Shamrock combines mountain views with affordable, self-contained accommodation, in a superb family environment, giving a great value holiday.

KITCHEN & COOKING FACILITIES

Full Kitchen:

Full Size Fridge

Microwave

Full Size Oven

4 Burner Cooker

BEDROOMS & BEDDING CONFIGURATION

This property sleeps 4 people. There are 2 Bedrooms with the following configuration.

Bedroom 1: 1 x Double bed

Bedroom 2: 1 x Trilogy Bunk

Linen, Towels and Bedding is provided for all beds.

BATHROOMS

1 x Bathroom with a shower over bath

HEATING & COOLING FACILITIES

Hydronic Heating

LAUNDRY DETAILS

No Laundry facilities

ENTERTAINMENT FACILITIES

Flat Screen TV

DVD Player

SMOKING

This is a Non-Smoking Apartment

Shamrock 8

2 Gallows Court, Hotham Heights



MT HOTHAM
ACCOMMODATION

Shamrock 8

2 Gallows Court, Mount Hotham



MT HOTHAM
ACCOMMODATION

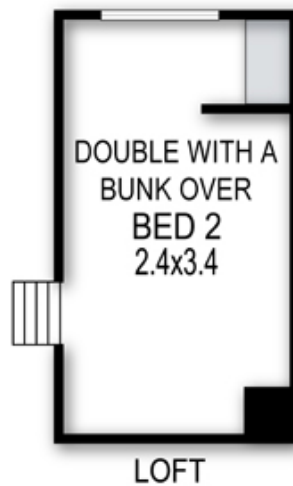

archistyle

Whilst every attempt has been made to ensure the accuracy of this floorplan, measurements of doors, windows, rooms and any other items are approximate only. The producer or the agent cannot be held responsible for any errors, omissions or misstatements. This plan is for illustrative purposes only and should be used as such.