

# Fountains 6

6/11 Higgi Drive, Hotham Heights, VIC. 3741



## FEATURES:

---



8 Occupancy



2 Bedroom



1 Bathroom



Dish Washer



Washing Machine

## ABOUT THIS PROPERTY

---

Fountains apartments offer some of the most impressive views Hotham has to offer, this lovely apartment has large floor to ceiling windows in the main living area which expose the northerly views. This apartment has two bedrooms, one bathroom and all the ingredients for a great holiday at Hotham.

**Check-In:** After 4pm **Check-Out:** Before 10am.

**Over Snow:** 2 trips IN and 2 trips OUT included to assist with your luggage.

[Click Here To See Mt Hotham Village Directory](#)

## KITCHEN & COOKING FACILITIES

---

Full Kitchen- Oven, Microwave, Full-Size Fridge, Dishwasher,

## BEDROOMS & BEDDING CONFIGURATION

---

Bedroom 1: 2 x Bunk Beds

Bedroom 2: 1 x Double Bed and 2 x Single Beds

## BATHROOMS

---

1 x Bathroom

## HEATING & COOLING FACILITIES

---

Electric panel heating & gas log in lounge

## LAUNDRY DETAILS

---

- Washing Machine
- Dryer

## ENTERTAINMENT FACILITIES

---

TV, DVD Player and Sound system

## EXTRA FACILITIES

---

Drying Cupboard

## PARKING

---

Hotham overnight car parking - **Resort Entry will need to be purchased**

## SMOKING

---

This is a Non-Smoking Apartment

## Fountain 6

11 Higgi Drive, Mount Hotham

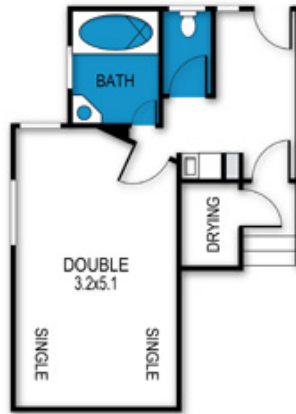

GROUND FLOOR



LOWER LEVEL

archistyle

Whilst every attempt has been made to ensure the accuracy of this floorplan, measurements of doors, windows, rooms and any other items are approximate only. The producer or the agent cannot be held responsible for any errors, omissions or misstatements. This plan is for illustrative purposes only and should be used as such.

# Fountains 6

6/11 Higgi Drive, Hotham Heights, VIC. 3741



MT HOTHAM  
ACCOMMODATION

